

**Pipe penetration waterproofing with  
AQUAFIN®-2K or AQUAFIN®-2K/M**  
(Load: ground moisture and non rising seepage water )



**MSASA**  
Construction Solutions for Africa

**CAPE TOWN**

Tel: +27 (0)87 231 0253  
Unit 5 | M5 Freeway Park  
Upper Camp Rd | Maitland | 7405  
Cape Town | South Africa  
Email: info@msasa.co.za | www.msasa.co.za

**JOHANNESBURG**

Tel: +27 (0)82 785 8529  
64 Maple Street | Pomona  
Kempton Park | Johannesburg | 1619  
South Africa

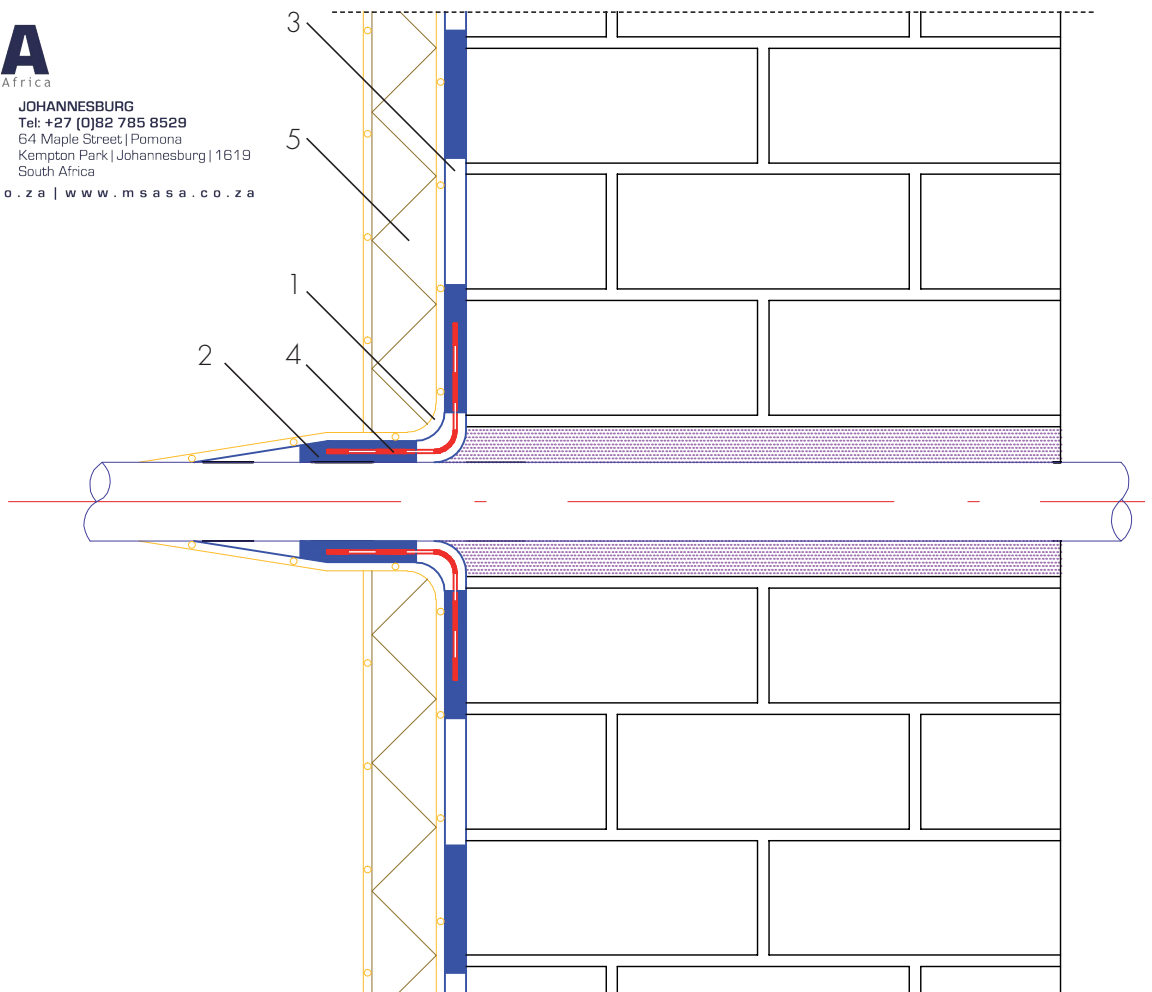

- 1 Cove with  $R > 4$  cm formed with ASOCRETRN cementitious mortar
- 2 Pipe surface abraded and degreased with Universal Cleanser
- 3 AQUAFIN-2K or AQUAFIN-2K/M waterproofing
- 4 ASO-Joint-Sleeve sealing gasket
- 5 Waterproofing protection layer with INA Schutz- und Drainelement (INA-Protective board)