

Interior swimming pool wall/floor joint (thin bed)

Exposure class B



MSASA
Construction Solutions for Africa

CAPE TOWN

Tel: +27 (0)87 231 0253

Unit 5 | M5 Freeway Park

Upper Camp Rd | Maitland | 7405

Cape Town | South Africa

JOHANNESBURG

Tel: +27 (0)82 785 8529

64 Maple Street | Pomona

Kempton Park | Johannesburg | 1619

South Africa

Email: info@msasa.co.za | www.msasa.co.za

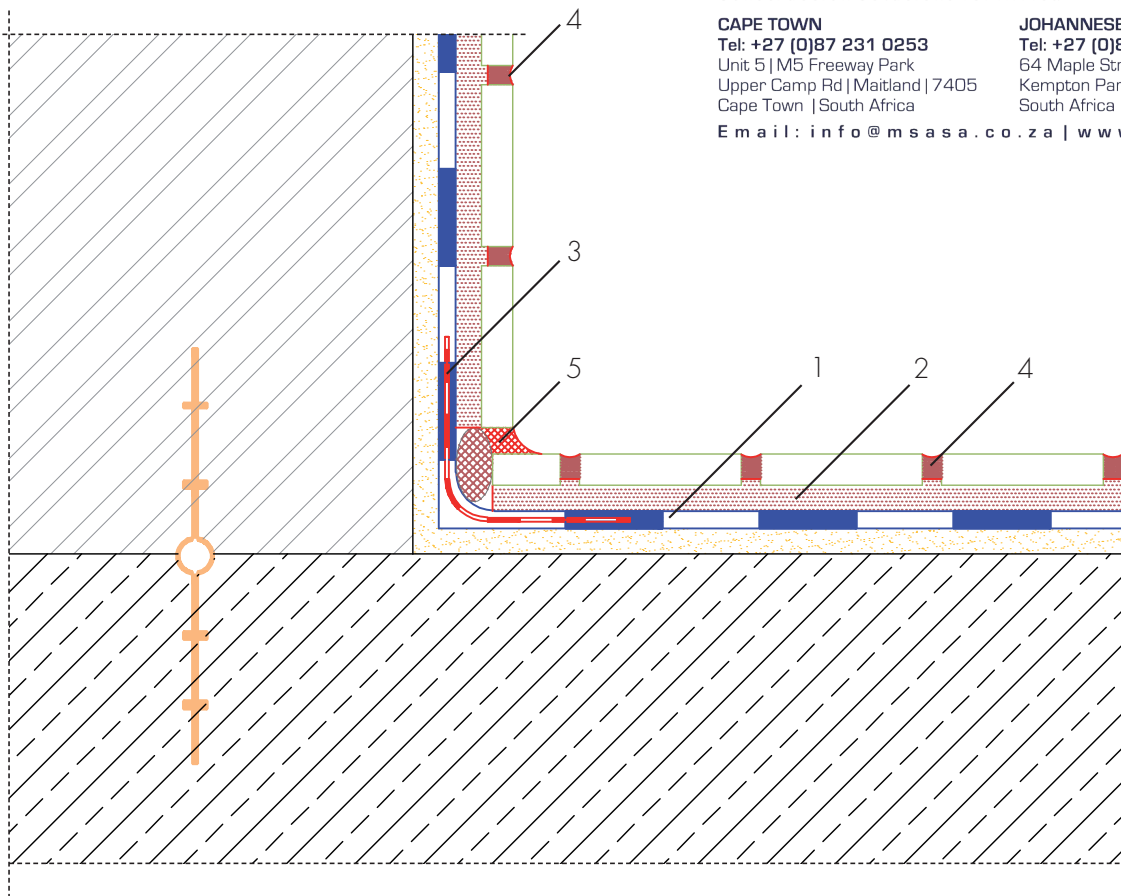

- 1 AQUAFIN-2K/M waterproofing
- 2 UNIFIX-2K/6 or SOLOFLEX tile adhesive
- 3 ASO-Joint-Tape-2000-S
- 4 ASODUR-EK98 or HF05-Brilliantfuge tile grout
- 5 ASO-backer rod and elastic sealer
ESCOSIL-2000-UW caulk