

## XYPEX - LEVEL 1

ABOVE GROUND - NOT SUBJECT TO HYDROSTATIC PRESSURE

### DAY JOINTS

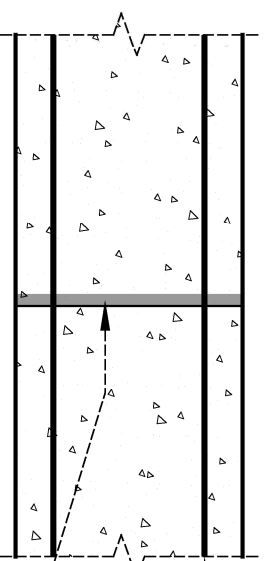

### WALL / SLAB INTERFACE

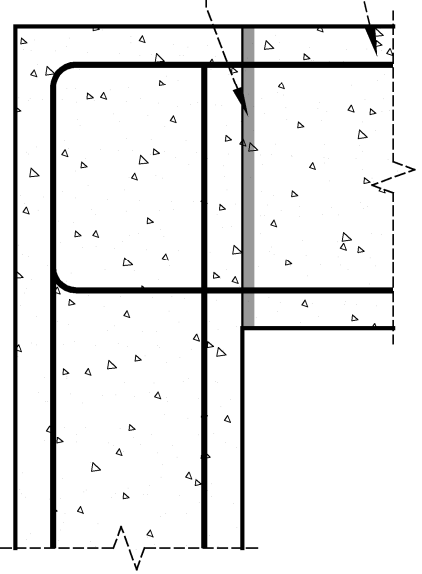

#### PRODUCT INFORMATION / SPECIFICATIONS:

1. Refer to the Product Data Sheet for XYPEX Concentrate.
2. These details for static (non-moving) joints only. To be approved by consulting engineer.

DRAWING TITLE:

**STANDARD CONSTRUCTION JOINT DETAILS: LEVEL 1**

For professional advice & project specific assistance, please contact:

tel: 087 231 0253

email: [info@xypex.co.za](mailto:info@xypex.co.za)

web: [www.xypex.com](http://www.xypex.com)